



22000 Industrial Blvd, Rogers, MN 55374  
866-527-7637  
www.motoalliance.com

## DENALI Plow Mount MA11724 Yamaha Rhino / Odes Dominator

Thank you for purchasing a DENALI plow mount. You now own a premium, custom plow mount to allow you to use your plow with your UTV/SxS. Please note the following instructions and heed all warnings.

- Your UTV/SxS and plow system can cause death or injury. Please use caution and common sense when operating your unit.
- Read your Plow Operator Manual, your Winch Operator Manual, and all warning labels before operating your UTV/SxS.
- Operate your UTV/SxS at a walking speed with the blade installed. Do not exceed 5 mph (8 km/h) even with the blade up.
- Do not operate the UTV/SxS on slopes greater than 10 degrees with the plow installed.
- Always lower the plow to the down position before leaving your UTV/SxS unattended.

**SEVERE INJURY OR DEATH MAY RESULT IF YOU ARE NEGLIGENT.**

Please verify that all hardware and parts are included in your package.

**DENALI Yamaha Rhino/Odes Dominator  
MA11724**



22000 Industrial Blvd  
Rogers, MN 55374  
866.527.7637

**Kit Contents:**

Item Number	Description	Quantity
1	Mount Plate (MA11724-W2)	1
2	U-shaped Clamps (MA11724-W1)	2
3	Tow Rear Mounting Straps (MA11724-5)	2
4	HBOLT 0.3125-18x1x1-S (5/16" x 1")	4
5	Regular Flat Washer (FW) 0.3125	4
6	Regular Lock Washers (LW) 0.3125	4
7	HBOLT 0.3125-18x3.75 (5/16" x 3.75")	4

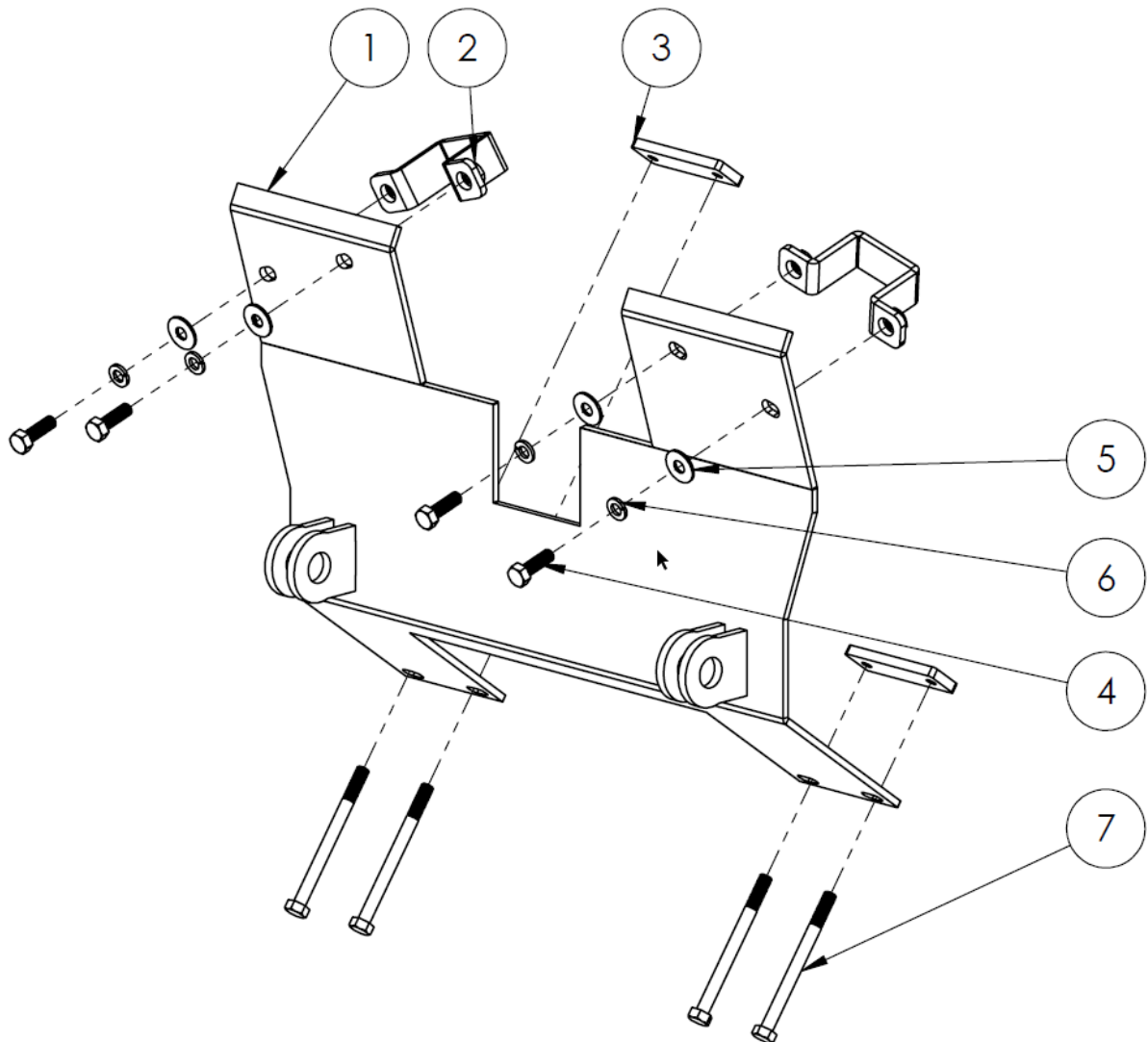



### Installation Instructions

**Overview:** The plow mount on this model mounts to the front of the machine and also attaches to the bottom between the suspension arm and front drive shafts, shown in the illustration.

1. Place the U-shaped Clamps around the top of the front bumper tube. Place the Mount Plate on the front of the machine, as shown in Figure 1. Place one Lock Washer and one Flat Washer onto one 5/16 x 1" Bolt. Insert Bolt through the plate and clamp, using the welded nut on the clamp to secure the bolt.



**Figure 1**



2. Adjust plate to fit on the machine and hand tighten bolts to hold everything into position, as shown in Figure 2. To mount the back, you will need to drill the two inside holes of the mount plate. **Note the orientation of the mount, with the 1" angled flange up.**

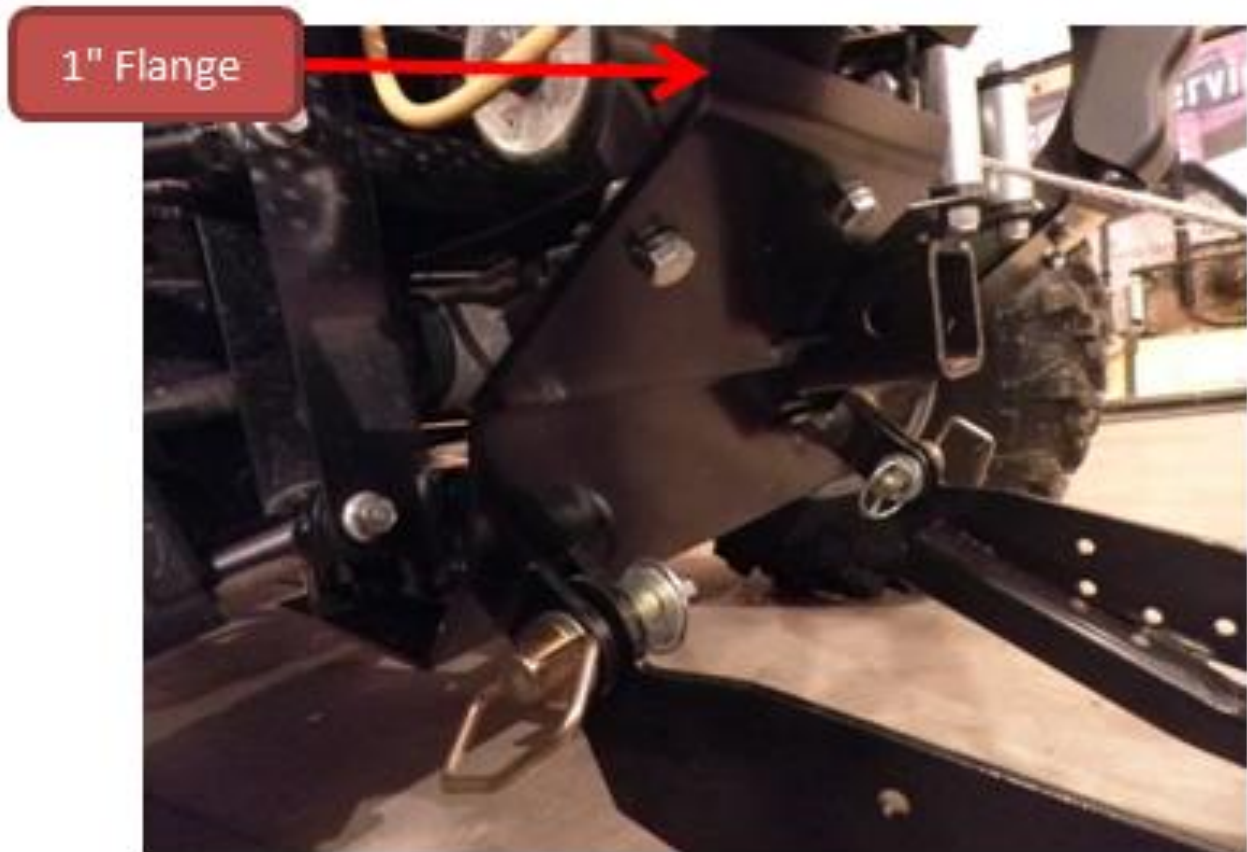

**Figure 2**



3. Use a 5/16" drill bit and the plow mount for a template and drill two holes in the plastic skid plate. Place the tow rear mounting straps over the front frame, as shown in Figure 3. Start the four 5/16 x 3 3/4" Bolts, Lock Washers and Flat Washers, adjust plate for best fit then tighten the eight bolts.



**Figure 3**